

SPOTSYLVANIA COUNTY, VIRGINIA
 E911 GPS SURVEY REVISED 10/2008

W.O. 95007

MAP PROJECTION: LAMBERT ORDER OF SURVEY: FIRST
 NAD 83(2007) * VIRGINIA STATE PLANE COORDINATE SYSTEM * NORTH ZONE

COUNTY	NAME OF STATION	YEAR
STAFFORD	DUFF 1	1995

N: 6785603.82	E: 11791376.71	LAT.: 38°16'35.91294"N	LONG.: 77°25'31.64324"W
GRID FACTOR: 0.99996598	SEA LEVEL FACTOR: 1.00000258	ϕ ANGLE: +0°40'14.31"	

ESTABLISHED BY: GeoMetrics GPS, INC.	YEAR 1995	DISTANCES AND DIRECTIONS TO REFERENCE MARKS AND PROMINENT OBJECTS OBSERVED AT STATION	
		OBJECT	MAG. AZIMUTH
VERTICAL DATUM NAVD 88			
ELEVATION (FT.) 52.70			
RECOVERED: OCT 2000			

DESCRIPTION OF STATION:

The station is a Stafford County survey disk set in concrete stamped DUFF 1 14 located in Stafford County, Virginia, approximately 2.7 miles southeast of Fredericksburg. To reach the station from the intersection of Route 3 Bypass (Blue Gray Parkway) and Route 3 Business (Kings Highway) proceed southeast along Route 3 (Kings Highway) 1.3 miles to the station on the left. No place to set a witness post.

SKETCH OF STATION:

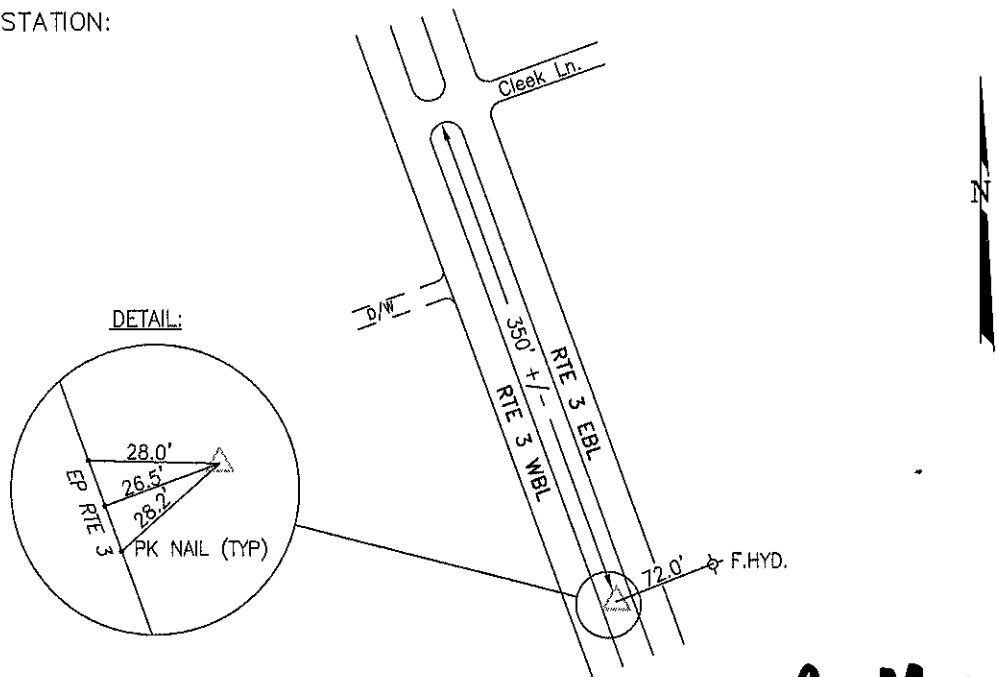

THIS SURVEY DATA PREPARED
 USING 1 meter = 3.280833 feet

PREPARED BY: EJP	DATE: AUG '95
CHECKED BY: DAR	DATE: AUG '95

NOTE:
 IN 2008 THE COORDINATES WERE CONVERTED TO
 NAD83(2007) BY APPLYING A COMPUTED SHIFT

GEOMETRICS
 ops, inc.

236 CAMBRIDGE ROAD
 FREDERICKSBURG, VIRGINIA
 (540) 372-3499