

SPOTSYLVANIA COUNTY VIRGINIA 2002 CONTROL SURVEY

JN 102-040

HORIZONTAL DATUM: NAD 83(2007) (REVISED 8-08)
 VERTICAL DATUM: NAVD 88
 COORDINATE SYSTEM: VIRGINIA STATE PLANE, NORTH ZONE
 UNITS: U.S. SURVEY FOOT

HORIZONTAL ORDER: FIRST
 VERTICAL ORDER: THIRD

COUNTY	NAME OF STATION	YEAR
SPOTSYLVANIA	PONAX	2002
N: 6751077.63	LAT: 38° 10' 57.39364" N	COMBINED FACTOR: 0.99996957
E: 11766388.28	LONG: 77° 30' 49.64601" W	⊖ ANGLE: 0° 36' 55.8"
ELEVATION: 262.18 (ESTABLISHED BY GPS)		
DISTANCES AND DIRECTIONS TO AZIMUTH MARKS		
STATION	GROUND DISTANCE	TRUE AZIMUTH
PONAX AZ	3969.66'	201°19'50"

THE STATION IS LOCATED IN SPOTSYLVANIA COUNTY, VIRGINIA APPROXIMATELY 7.5 MILES SOUTH FROM THE CITY FREDERICKSBURG AT THE MASSAPONAX HIGH SCHOOL.

TO REACH THE STATION FROM THE INTERSECTION OF US HIGHWAY 1 (JEFFERSON DAVIS HIGHWAY) AND US HIGHWAY 17 (MILLS DRIVE) IN MASSAPONAX PROCEED SOUTH ALONG US HIGHWAY 1 (JEFFERSON DAVIS HIGHWAY) A DISTANCE OF APPROXIMATELY 3.3 MILES TO THE STATION ON THE LEFT.

THE STATION IS A 3 1/2 INCH SPOTSYLVANIA COUNTY, VA ALUMINUM SURVEY DISK SET IN A POURED IN PLACE CONCRETE MONUMENT FLUSH WITH THE GROUND SURFACE AND STAMPED PONAX 2002.

THE STATION IS INTERVISIBLE WITH STATION PONAX AZ 2002.

SKETCH:

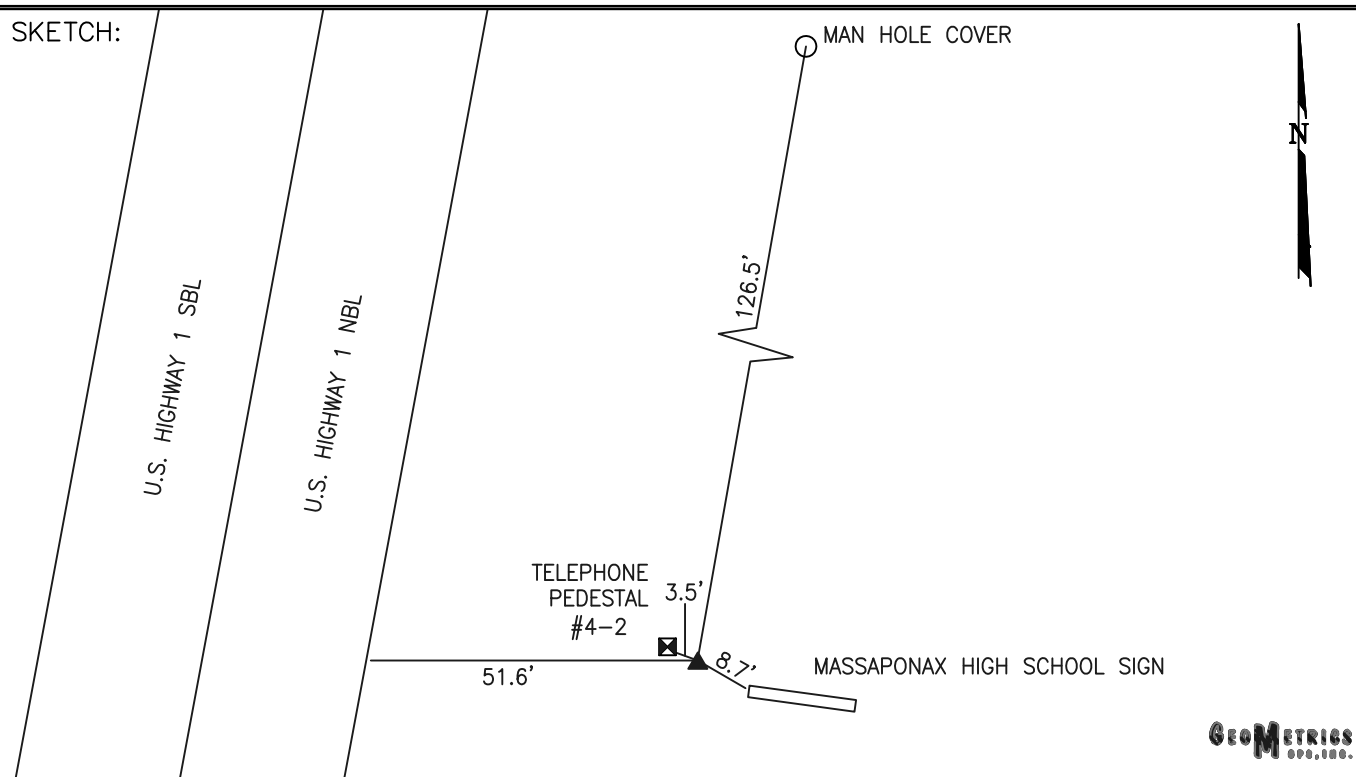

GEO METRICS
CONSULTING

DRAWN BY: KNT

CHECKED BY: CEN

DATE: 08/2002

APPROX. SCALE: 1" = 30'