

SPOTSYLVANIA COUNTY, VIRGINIA  
 GEODETIC SURVEY CONTROL REVISED 10/2008

MAP PROJECTION: LAMBERT  
 NAD 83(2007) \* VIRGINIA STATE PLANE COORDINATE SYSTEM \* NORTH ZONE

HORIZONTAL ORDER OF SURVEY: THIRD

COUNTY		NAME OF STATION		YEAR
SPOTSYLVANIA		88-0134		2000
N: 6722617.52	E: 11715528.65	LAT.: 38°06'20.97395"N	LONG.: 77°41'29.74205"W	
GRID FACTOR: 0.9999879969	COMBINED FACTOR: 0.99997715		ϕ ANGLE: +0°30'16"	
ESTABLISHED BY: VDOT	YEAR 1999	DISTANCES AND DIRECTIONS TO REFERENCE MARKS AND PROMINENT OBJECTS OBSERVED AT STATION		
		OBJECT	DISTANCE-FT.	AZIMUTH
VERTICAL DATUM	NAVD 88	Power Pole	33.30'	230° 00' 00"
ELEVATION (FT.)	333.25	Telephone Junction Box	10.25'	270° 00' 00"
VERTICAL ORDER: THIRD	c/l of Rt. 656 (Towles Mill Road)		38.60'	294° 00' 00"

DESCRIPTION OF STATION:

Standard metal VDOT disk stamped 88-0134, set in concrete flush with the ground surface.

To reach this monument from the intersection of Rt. 614 (Dickerson Road) and Route 656 (Towles Mill Road), proceed north northeast along Rt. 656 (Towles Mill Road) a distance of 0.15 miles to the monument on the right.

SKETCH OF STATION:

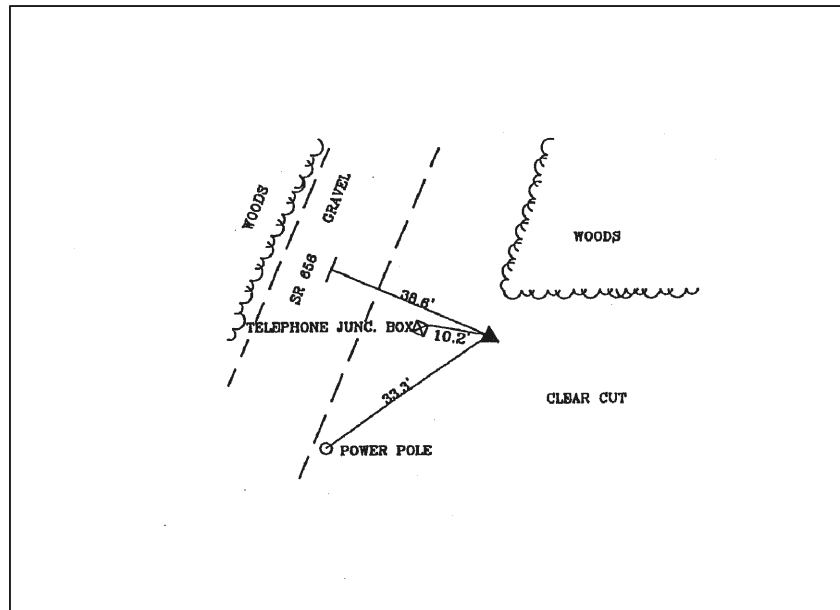

THIS SURVEY DATA PREPARED  
 USING 1 meter = 39.37 inches

NOTE:  
 IN 2008 THE COORDINATES WERE CONVERTED TO  
 NAD83(2007) BY APPLYING A COMPUTED SHIFT

PREPARED BY: KRO	DATE: JAN '01
CHECKED BY: DAR	DATE: JAN '01

**GEOMETRICS**  
 OPS, INC.  
 236 CAMBRIDGE STREET  
 FREDERICKSBURG, VIRGINIA  
 (540) 372-3499