

SPOTSYLVANIA COUNTY, VIRGINIA
 GEODETIC SURVEY CONTROL REVISED 10/2008

MAP PROJECTION: LAMBERT
 NAD 83(2007) * VIRGINIA STATE PLANE COORDINATE SYSTEM * NORTH ZONE

HORIZONTAL ORDER OF SURVEY: THIRD

COUNTY		NAME OF STATION		YEAR
SPOTSYLVANIA		88-0118		2000
N: 6756370.98	E: 11737062.10	LAT.: 38°11'52.67272"N	LONG.: 77°36'56.28046"W	
GRID FACTOR: 0.9999750259	COMBINED FACTOR: 0.99996513		ϕ ANGLE: +0°33'07"	
ESTABLISHED BY: VDOT	YEAR 1998	DISTANCES AND DIRECTIONS TO REFERENCE MARKS AND PROMINENT OBJECTS OBSERVED AT STATION		
		OBJECT	DISTANCE-FT.	AZIMUTH
VERTICAL DATUM		88-0119	Unknown	246° 03' 43"
ELEVATION (FT.)				
VERTICAL ORDER: THIRD				

DESCRIPTION OF STATION:

Standard metal VDOT disk stamped 88-0118, set in concrete flush with the ground surface.

This monument is located in the north east quadrant of the Route 648 (Blockhouse Road) and Route 608 (Robert E Lee Drive) intersection.

SKETCH OF STATION:

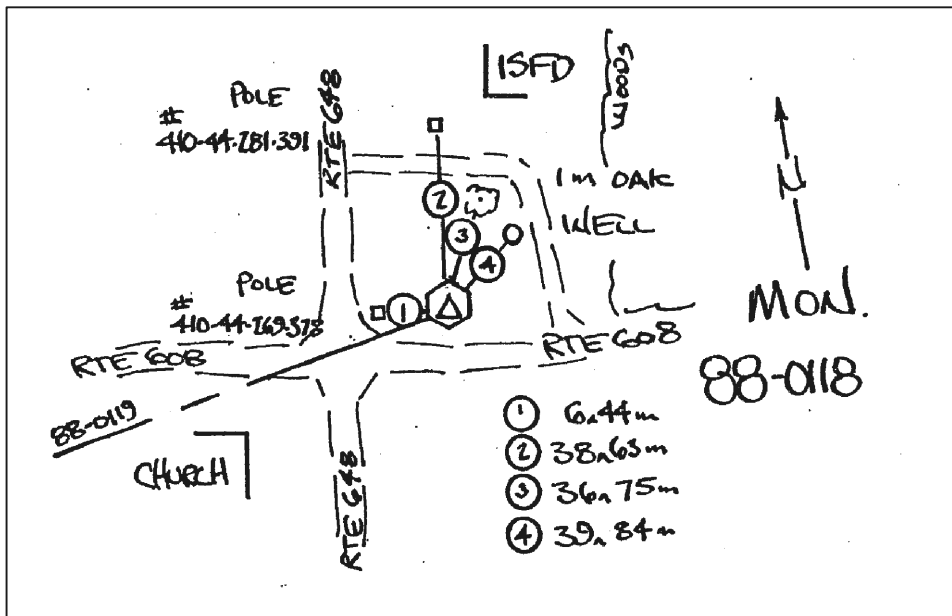

THIS SURVEY DATA PREPARED
 USING 1 meter = 39.37 inches

NOTE:

COORDINATE AND ELEVATION DATA LISTED ABOVE IS
 CONVERTED TO NAD83/93 AND NAVD88 BY USING
 CORPSCON. IN 2008 THE COORDINATES WERE CONVERTED
 TO NAD83(2007) BY APPLYING A COMPUTED SHIFT.

GEOMETRICS
 GPS, INC.
 236 CAMBRIDGE STREET
 FREDERICKSBURG, VIRGINIA
 (540) 372-3499

PREPARED BY: KRO	DATE: JAN '01
CHECKED BY: DAR	DATE: JAN '01