

SPOTSYLVANIA COUNTY, VIRGINIA
 GEODETIC SURVEY CONTROL REVISED 10/2008

MAP PROJECTION: LAMBERT
 NAD 83(2007) * VIRGINIA STATE PLANE COORDINATE SYSTEM * NORTH ZONE

HORIZONTAL ORDER OF SURVEY: THIRD

COUNTY		NAME OF STATION		YEAR
SPOTSYLVANIA		88-0112		2000
N: 6745009.15	E: 11730862.00	LAT.: 38°10'00.94171"N	LONG.: 77°38'15.28249"W	
GRID FACTOR:		COMBINED FACTOR:		∅ ANGLE:
ESTABLISHED BY: VDOT	YEAR 1998	DISTANCES AND DIRECTIONS TO REFERENCE MARKS AND PROMINENT OBJECTS OBSERVED AT STATION		
		OBJECT	DISTANCE-FT.	MAG. AZIMUTH
VERTICAL DATUM NONE				
ELEVATION (FT.)				
VERTICAL ORDER:				

DESCRIPTION OF STATION:

Standard metal VDOT disk stamped 88-0112 set in concrete flush with the ground surface.

To reach this monument from the intersection of Rt. 208 (Courthouse Road) and Rt. 648 (Block House Road), proceed north on Rt. 648, 0.6 km. Monument is located 22 meters east of the centerline of the VDOT Right of Way.

Due to bad dog in yard at time of survey, unable to provide monument data!

SKETCH OF STATION:

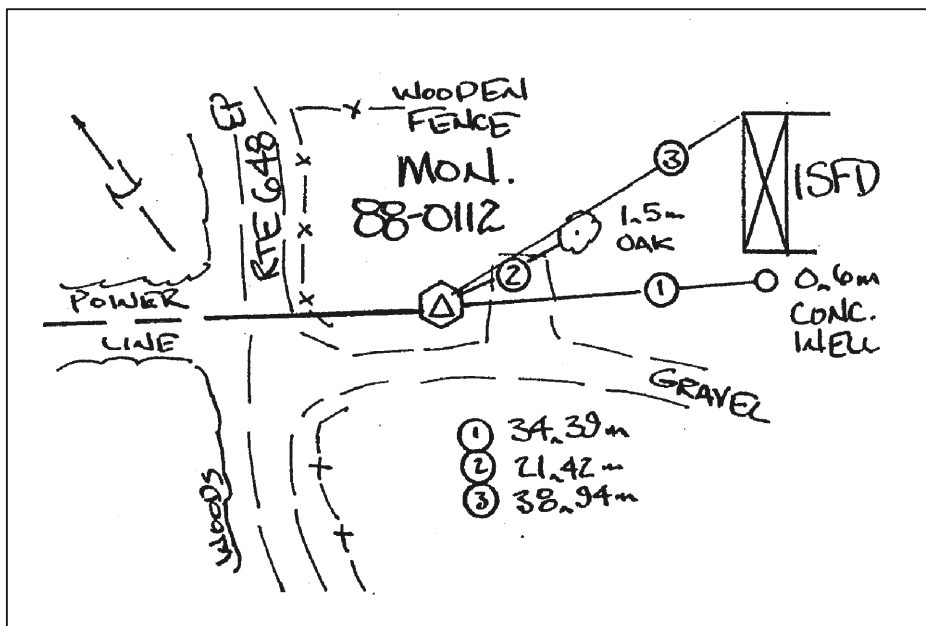

THIS SURVEY DATA PREPARED
 USING 1 meter = 39.37 inches

NOTE:

COORDINATE AND ELEVATION DATA LISTED ABOVE IS
 CONVERTED TO NAD83/93 AND NAVD88 BY USING
 CORPSCON. IN 2008 THE COORDINATES WERE CONVERTED
 TO NAD83(2007) BY APPLYING A COMPUTED SHIFT.

GEOMETRICS
 OPS, INC.

236 CAMBRIDGE STREET
 FREDERICKSBURG, VIRGINIA
 (540) 372-3499

PREPARED BY: KRO	DATE: JAN '01
CHECKED BY: DAR	DATE: JAN '01