

SPOTSYLVANIA COUNTY, VIRGINIA
 GEODETIC SURVEY CONTROL REVISED 10/2008

MAP PROJECTION: LAMBERT
 NAD 83(2007) * VIRGINIA STATE PLANE COORDINATE SYSTEM * NORTH ZONE

HORIZONTAL ORDER OF SURVEY: THIRD

COUNTY		NAME OF STATION		YEAR
SPOTSYLVANIA		88-0102		2000
N: 6780244.36	E: 11758663.62	LAT.: 38°15'46.51878"N	LONG.: 77°32'22.56518"W	
GRID FACTOR: 0.99996742	COMBINED FACTOR: 0.99995866		ϕ ANGLE: +0°35'58"	
ESTABLISHED BY: VDOT	YEAR 1997	DISTANCES AND DIRECTIONS TO REFERENCE MARKS AND PROMINENT OBJECTS OBSERVED AT STATION		
		OBJECT	DISTANCE-FT.	MAG. AZIMUTH
VERTICAL DATUM	NAVD 88	88-0101	836.060 m	S 7° 26' 04" W
ELEVATION (FT.)	289.79			
VERTICAL ORDER:	THIRD			

DESCRIPTION OF STATION:

Standard metal VDOT disk, stamped 88-0102, set in concrete flush with the ground.

To reach this monument from the intersection of Rt. 208 (Courthouse Road) and Rt. 639 (Leavells Road), proceed north on Rt. 639 (Leavells Road) 1.65 miles. Monument is 14.87 meters right of the edge of pavement of Rt. 639 (Leavells Road).

*Monument might be disturbed or destroyed due to construction.

SKETCH OF STATION:

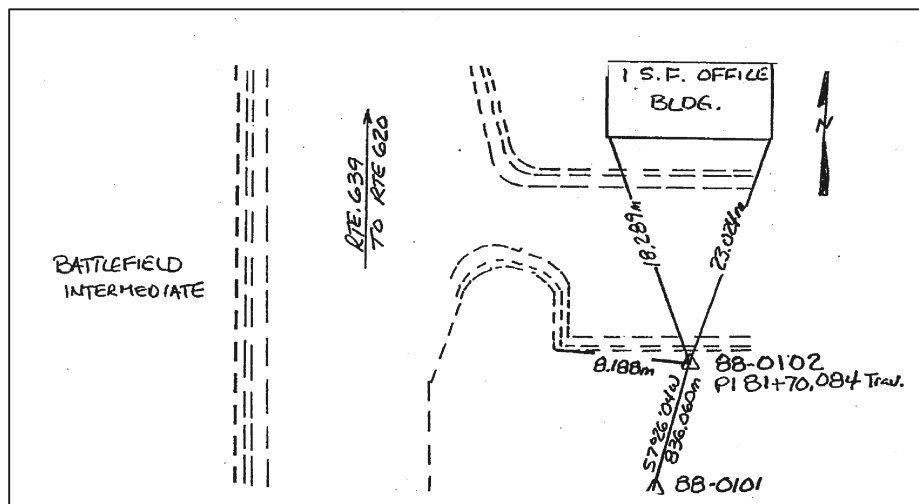

THIS SURVEY DATA PREPARED
 USING 1 meter = 39.37 inches

NOTE:

COORDINATE AND ELEVATION DATA LISTED
 ABOVE IS CONVERTED TO NAD83/93 AND
 NAVD88 BY USING CORPSCON. IN 2008 THE
 COORDINATES WERE CONVERTED TO
 NAD83(2007) BY APPLYING A COMPUTED SHIFT.

GEOMETRICS
 OPS, INC.

236 CAMBRIDGE STREET
 FREDERICKSBURG, VIRGINIA
 (540) 372-3499

PREPARED BY: KRO	DATE: JAN '01
CHECKED BY: DAR	DATE: JAN '01