

SPOTSYLVANIA COUNTY, VIRGINIA  
 GEODETIC SURVEY CONTROL REVISED 10/2008

MAP PROJECTION: LAMBERT

HORIZONTAL ORDER OF SURVEY: THIRD

NAD 83(2007) \* VIRGINIA STATE PLANE COORDINATE SYSTEM \* NORTH ZONE

COUNTY		NAME OF STATION		YEAR
SPOTSYLVANIA		88-0090		2000
N: 6792121.50	E: 11765193.81	LAT.: 38°17'43.24145"N	LONG.: 77°30'59.09764"W	
GRID FACTOR: 0.99996410	COMBINED FACTOR: 0.99995726		⊕ ANGLE: +0°36'50"	
ESTABLISHED BY: VDOT	YEAR 1995	DISTANCES AND DIRECTIONS TO REFERENCE MARKS AND PROMINENT OBJECTS OBSERVED AT STATION		
		OBJECT	DISTANCE-FT.	MAG. AZIMUTH
VERTICAL DATUM	NAVD 88	88-0089	2939.05'	N 81° 39' 17" E
ELEVATION (FT.)	249.75			
VERTICAL ORDER:	THIRD			

DESCRIPTION OF STATION:

Standard metal VDOT disk stamped 88-0090 set in concrete .10' below ground surface.

To reach the monument from I-95 overpass, proceed west on Rt. 3, 0.571 miles. Monument is 90.12' right of the station 142+02.50 POT West Bound Lane (WBL).

SKETCH OF STATION:

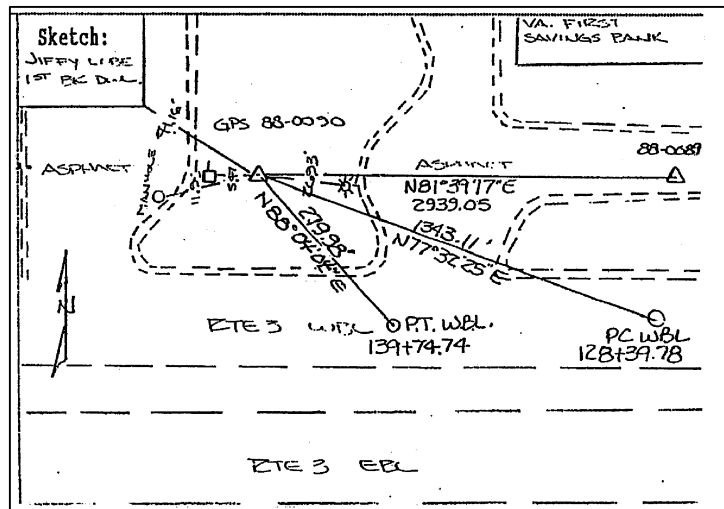

NOTE:

COORDINATE AND ELEVATION DATA LISTED ABOVE IS CONVERTED TO NAD83/93 AND NAVD88 BY USING CORPSCON. IN 2008 THE COORDINATES WERE CONVERTED TO NAD83(2007) BY APPLYING A COMPUTED SHIFT.

THIS SURVEY DATA PREPARED  
 USING 1 meter = 39.37 inches

PREPARED BY: KRO	DATE: JAN '01
CHECKED BY: DAR	DATE: JAN '01

**GEOMETRICS**  
 ops, inc.  
 236 CAMBRIDGE STREET  
 FREDERICKSBURG, VIRGINIA  
 (540) 372-3499