

SPOTSYLVANIA COUNTY, VIRGINIA

GEODETIC SURVEY CONTROL REVISED 10/2008

MAP PROJECTION: LAMBERT

HORIZONTAL ORDER OF SURVEY: THIRD

NAD 83(2007) * VIRGINIA STATE PLANE COORDINATE SYSTEM * NORTH ZONE

| | | | | |
|---------------------------|-----------------------------|--|-------------------------|-----------------|
| COUNTY | | NAME OF STATION | | YEAR |
| SPOTSYLVANIA | | 88-0084 | | 2000 |
| N: 6809008.03 | E: 11734156.16 | LAT.: 38°20'33.27352"N | LONG.: 77°37'26.38949"W | |
| GRID FACTOR: 0.9999598322 | COMBINED FACTOR: 0.99995144 | | ⊕ ANGLE: +0°32'48" | |
| ESTABLISHED BY: VDOT | YEAR 1994 | DISTANCES AND DIRECTIONS TO REFERENCE MARKS AND PROMINENT OBJECTS OBSERVED AT STATION | | |
| | | OBJECT | DISTANCE-FT. | MAG. AZIMUTH |
| VERTICAL DATUM | NAVD 88 | 88-0085 | 1834.64' | N 51° 10' 21" E |
| ELEVATION (FT.) | 281.68 | 88-0088 | 1158.84' | S 55° 28' 00" E |
| VERTICAL ORDER: THIRD | | | | |

DESCRIPTION OF STATION:

Standard metal VDOT disk stamped 88-0084 set in concrete 1" below ground surface.

To reach the monument from the intersection of Rt. 616 (US Ford Road) & Rt. 620 (Spotswood Furnace Road), proceed north on Rt. 616 (US Ford Road) 0.121 mile. Monument is 84' right of C/L of Rt. 616 (US Ford Road).

SKETCH OF STATION:

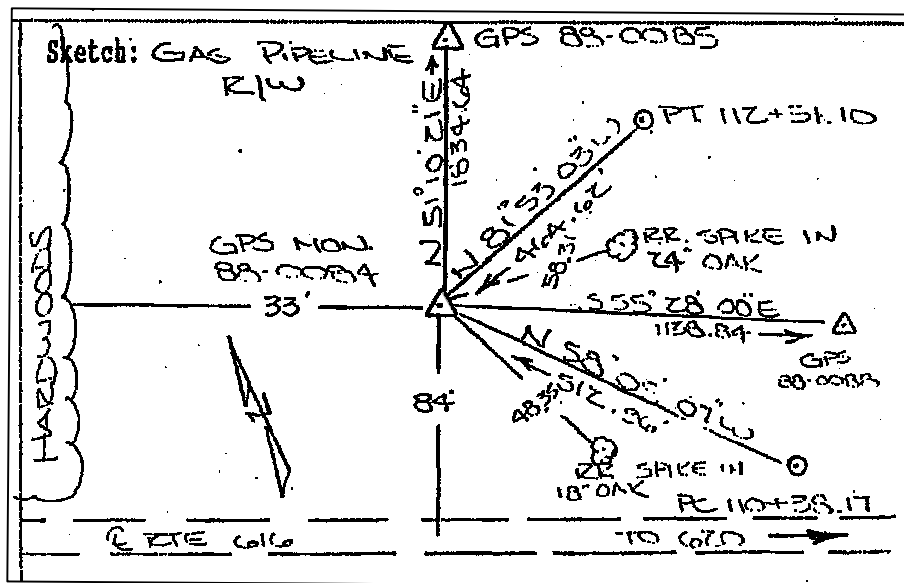

THIS SURVEY DATA PREPARED
USING 1 meter = 39.37 inches

| | |
|------------------|---------------|
| PREPARED BY: KRO | DATE: JAN '01 |
| CHECKED BY: DAR | DATE: JAN '01 |

NOTE:

COORDINATE AND ELEVATION DATA LISTED ABOVE IS CONVERTED TO NAD83/93 AND NAVD88 BY USING CORPSCON. IN 2008 THE COORDINATES WERE CONVERTED TO NAD83(2007) BY APPLYING A COMPUTED SHIFT.

GEOMETRICS
ops, inc.
236 CAMBRIDGE STREET
FREDERICKSBURG, VIRGINIA
(540) 372-3499