

**SPOTSYLVANIA COUNTY VIRGINIA
2003-2004 CONTROL SURVEY**

JN 103-060

HORIZONTAL DATUM: NAD 83(2007) (REVISED 8-08)
 VERTICAL DATUM: NAVD 88
 COORDINATE SYSTEM: VIRGINIA STATE PLANE, NORTH ZONE
 UNITS: U.S. SURVEY FOOT

HORIZONTAL ORDER: FIRST
 VERTICAL ORDER: THIRD

COUNTY	NAME OF STATION	YEAR
SPOTSYLVANIA	U 390	1960
N: 6757929.88	LAT: 38° 12' 04.93191" N	COMBINED FACTOR: 0.99997460
E: 11768234.96	LONG: 77° 30' 25.59070" W	⊖ ANGLE: 0° 37' 11"
ELEVATION: 242.71' (ESTABLISHED BY CGS)		
DISTANCES AND DIRECTIONS TO AZIMUTH MARKS		
STATION	GROUND DISTANCE	TRUE AZIMUTH
U 390 AZ	1402.37'	191° 26' 14"

THE STATION IS LOCATED IN SPOTSYLVANIA COUNTY, VIRGINIA, APPROXIMATELY 12.1 KM (7.5 MILES) SOUTHWEST OF THE CITY OF FREDERICKSBURG AND 7.1 KM (4.4 MILES) EAST OF THE SPOTSYLVANIA COURTHOUSE.

TO REACH THE STATION FROM THE INTERSECTION OF US HIGHWAY 1 (JEFFERSON DAVIS HIGHWAY) AND STATE ROUTE 608 (MASSAPONAX CHURCH ROAD) GO NORTH ON US HIGHWAY 1 FOR 0.8 KM (0.5 MILE) TO THE STATION ON THE RIGHT.

STATION U 390 IS INTERVISIBLE WITH STATION U 390 AZ.

SKETCH:

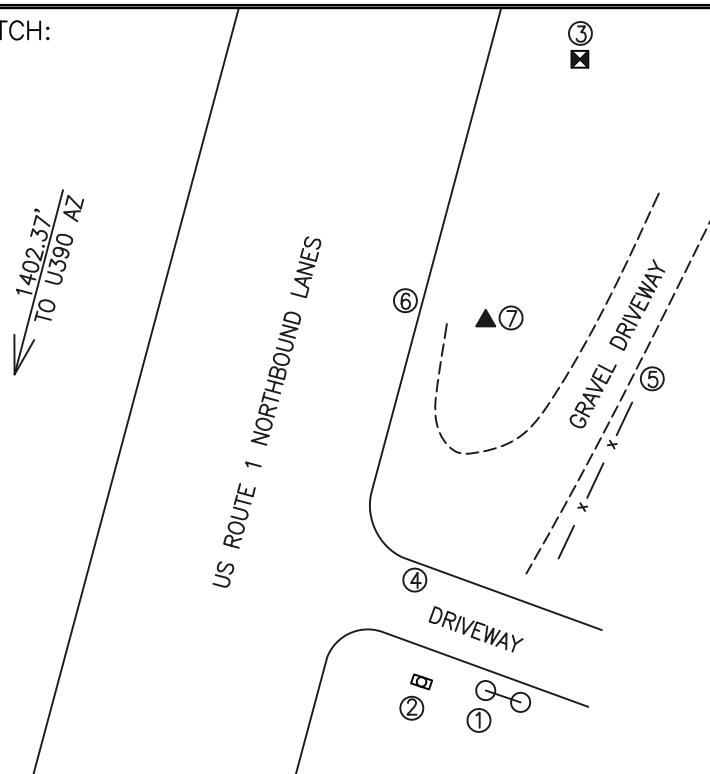

1. 97.0' TO WEST LEG OF "CAPITOL SHEDS" SIGN
2. 96.2' TO MAILBOX 8813
3. 71.7' TO TEL PED #5
4. 66.0' TO EP DRIVEWAY
5. 44.0' TO NE END OF WOODEN FENCE
6. 17.0' TO EP ROUTE 1
7. 1.7' TO WITNESS POST

