

**SPOTSYLVANIA COUNTY VIRGINIA  
2003-2004 CONTROL SURVEY**

JN 103-060

HORIZONTAL DATUM: NAD 83(2007) (REVISED 8-08)  
 VERTICAL DATUM: NAVD 88  
 COORDINATE SYSTEM: VIRGINIA STATE PLANE, NORTH ZONE  
 UNITS: U.S. SURVEY FOOT

HORIZONTAL ORDER: FIRST  
 VERTICAL ORDER: THIRD

COUNTY	NAME OF STATION	YEAR
SPOTSYLVANIA	SUMCROS AZ	2004
N: 6757960.12	LAT: 38° 12' 03.37796" N	COMBINED FACTOR: 0.99997465
E: 11785068.37	LONG: 77° 26' 54.71889" W	⊖ ANGLE: 0° 39' 22"
ELEVATION: 243.11' (ESTABLISHED BY GPS)		
DISTANCES AND DIRECTIONS TO AZIMUTH MARKS		
STATION	GROUND DISTANCE	TRUE AZIMUTH
SUMCROS	991.74'	126° 23' 17"

THE STATION IS LOCATED IN SPOTSYLVANIA COUNTY, VIRGINIA, APPROXIMATELY 12.2 KM (7.6 MILES) EAST OF THE SPOTSYLVANIA COURTHOUSE AND 11.3 KM (7.0 MILES) SOUTH OF THE CITY OF FREDERICKSBURG.

TO REACH THE STATION FROM THE INTERSECTION OF US HIGHWAY 17 SOUTH AND STATE ROUTE 608 (MASSAPONAX CHURCH ROAD) GO SOUTHWESTERLY ON STATE ROUTE 608 FOR 3.2 KM (2.0 MILES) TO ITS INTERSECTION WITH STATE ROUTE 668 (SUMMIT CROSSING ROAD). TURN LEFT AND GO EAST ON SUMMIT CROSSING ROAD FOR 1.9 KM (1.2 MILES) TO THE STATION ON THE RIGHT.

STATION SUMCROS AZ IS INTERVISIBLE WITH STATION SUMCROS.

THE STATION IS A 3 1/2 INCH SPOTSYLVANIA COUNTY, VA ALUMINUM SURVEY DISK SET INTO A POURED IN PLACE CONCRETE MONUMENT 10 INCHES IN DIAMETER, RECESSED ONE INCH BELOW THE GROUND SURFACE AND STAMPED SUMCROS AZ 2004.

SKETCH:

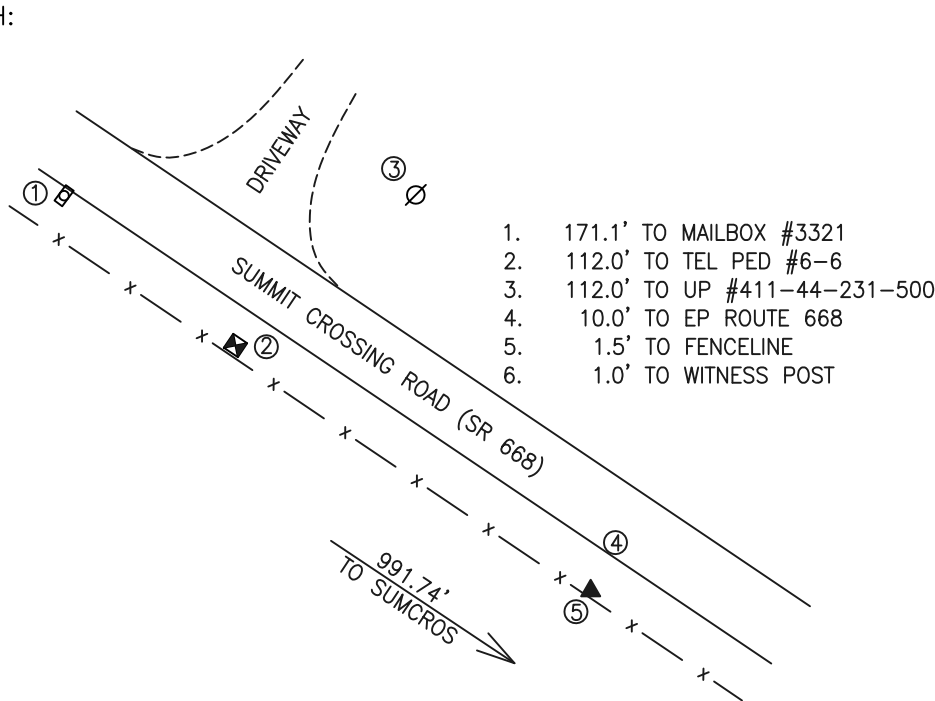

**GEOMETRICS**  
OPS, INC.