

SPOTSYLVANIA COUNTY, VIRGINIA  
 GEODETIC SURVEY CONTROL REVISED 10/2008

MAP PROJECTION: LAMBERT  
 NAD 83(2007) \* VIRGINIA STATE PLANE COORDINATE SYSTEM \* NORTH ZONE

HORIZONTAL ORDER OF SURVEY: THIRD

COUNTY	NAME OF STATION		YEAR
SPOTSYLVANIA	88-0116		2000
N: 6751177.72	E: 11735755.76	LAT.: 38°11'01.46038"N	LONG.: 77°37'13.26753"W
GRID FACTOR: 0.9999768615	COMBINED FACTOR: 0.99996942		ϕ ANGLE: +0°32'56"
ESTABLISHED BY: VDOT	YEAR 1998	DISTANCES AND DIRECTIONS TO REFERENCE MARKS AND PROMINENT OBJECTS OBSERVED AT STATION	
		OBJECT	DISTANCE-FT.      MAG.    AZIMUTH
VERTICAL DATUM			
ELEVATION (FT.)			
VERTICAL ORDER: THIRD			

DESCRIPTION OF STATION:

Standard metal VDOT disk stamped 88-0116, set in concrete flush with the ground surface.

To reach this monument from the bridge over the Po River on Rt. 648 (Blockhouse Road), proceed north on Rt. 648, 0.6 km. Monument is located 50 meters east of the centerline of the VDOT Right of Way.

\*Azimuth monument 88-0117 has been destroyed.

SKETCH OF STATION:

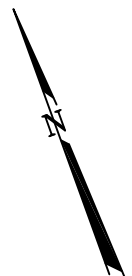
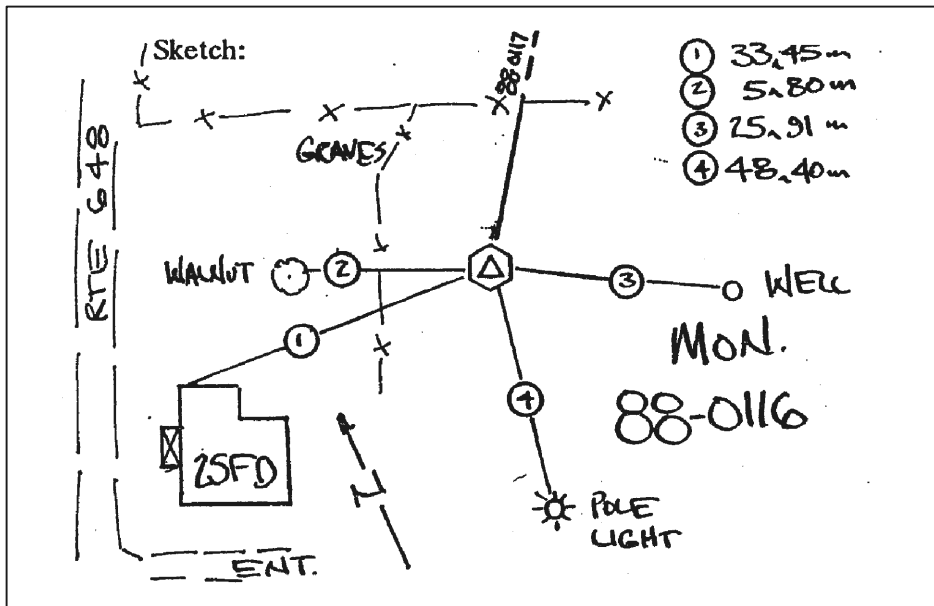

THIS SURVEY DATA PREPARED  
 USING 1 meter = 39.37 inches

NOTE:

COORDINATE AND ELEVATION DATA LISTED ABOVE IS  
 CONVERTED TO NAD83/93 AND NAVD88 BY USING  
 CORPSCON. IN 2008 THE COORDIANTES WERE CONVERTED  
 TO NAD83(2007) BY APPLYING A COMPUTED SHIFT.

**GEOMETRICS**  
 ops, inc.

236 CAMBRIDGE STREET  
 FREDERICKSBURG, VIRGINIA  
 (540) 372-3499

PREPARED BY: KRO	DATE: JAN '01
CHECKED BY: DAR	DATE: JAN '01